

REGIONAL MUNICIPALITY OF OTTAWA-CARLETON
MUNICIPALITÉ RÉGIONALE D'OTTAWA-CARLETON

REPORT
RAPPORT

Our File/N/Réf. **12 18-96-70036-000**
Your File/V/Réf.

DATE 14 March 1997

TO/DEST. Co-ordinator
Corporate Services and Economic Development Committee

FROM/EXP. Planning and Development Approvals Commissioner

SUBJECT/OBJET **SALE OF SURPLUS PROPERTY**
270 BEECHWOOD AVENUE
VILLAGE OF ROCKCLIFFE PARK

DEPARTMENTAL RECOMMENDATIONS

That the Corporate Services and Economic Development Committee and Council:

- 1. Declare the property described as being part of Beechwood Avenue, Registered Plan 92, Village of Rockcliffe Park, and shown as Part 1, Plan 4R-10798, surplus to Regional needs;**
- 2. Approve the sale of Part 1, Plan 4R-10798 to John Bruce deMercado for the amount of \$500.00 pursuant to an agreement of Purchase and Sale that has been received.**

BACKGROUND

The reconstruction and realignment of Beechwood Avenue created a parcel of land outside the limits of the right-of-way and surplus to the Region's needs. The subject parcel consists of 106.6 square metres and is of a size and nature that it is of value only to the abutting property owners.

On September 27, 1995 Regional Council approved the road closure of that portion of Beechwood Avenue shown as Part 1, Plan 4R-10798.

The property was offered to the adjacent owners resulting in an offer from John Bruce deMercado in the amount of \$500.00. The offer is considered to be fair and reasonable.

CONSULTATION

In accordance with existing policies, the availability of the property was circulated to all local governments and agencies. No interest was shown. The property is of value only to the adjacent land owners and as such was offered to them directly.

FINANCIAL STATEMENT

This transaction represents a revenue of \$500.00 to the Corporation.

The offer is considered to be fair and reasonable and is recommended for acceptance.

*Approved by
Nick Tunnacliffe, MCIP, RPP*

LJN/

FINANCE COMMENT

Proceeds from the sale of this property will be credited to Account No. 011-19909.

*Approved by T. Fedec
on behalf of the Finance Commissioner*

Attach. (1)

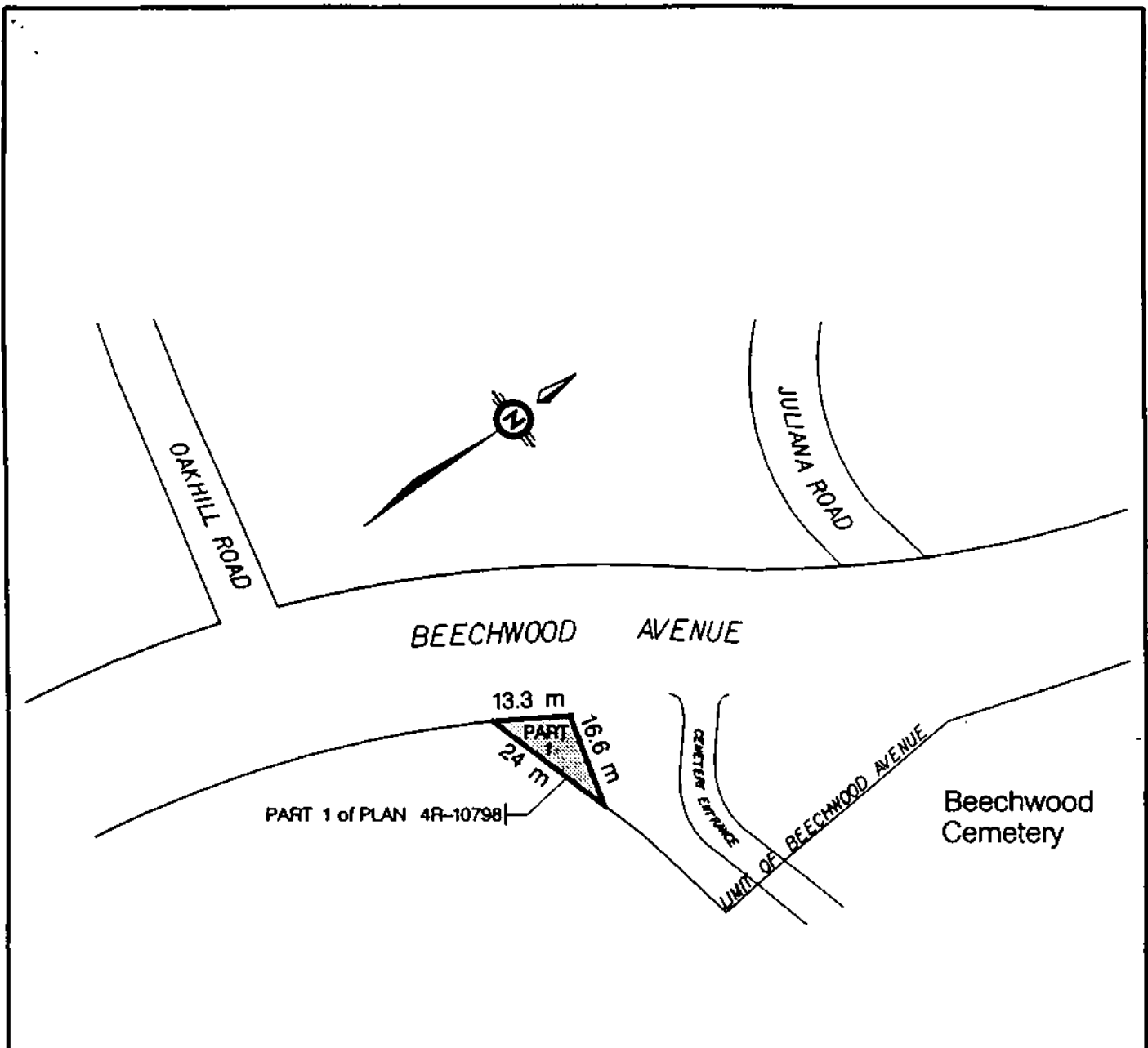

Legend

-  Portion of road to be closed
106.6 m²

ROAD CLOSING 270 BEECHWOOD AVENUE VILLAGE OF ROCKCLIFFE PARK		
SCALE N.T.S.	DRAWN BY T.F.	CHECKED BY
3314	DATE August '95	APPROVED BY



DEVELOPMENT SERVICES BRANCH
TRANSPORTATION PLANNING DIVISION