

2. NAMING REGIONAL ROAD 31, TOWNSHIP OF OSGOODE

COMMITTEE RECOMMENDATION

That Council approve the following proposed street name:

That former provincial Highway 31 (now Regional Road 31) from approximately 200 metres south of Mitch Owens Road to the Osgoode/Stormont Dundas & Glengary boundary, be named “BANK STREET” (see Annex 1).

DOCUMENTATION:

1. Planning and Development Approvals Commissioner’s report dated 2 June 98.

REGIONAL MUNICIPALITY OF OTTAWA-CARLETON
 MUNICIPALITÉ RÉGIONALE D'OTTAWA-CARLETON

REPORT
RAPPORT

Our File/N/Réf. (23) 28-98-0008
 Your File/V/Réf.

DATE 2 June 1998

TO/DEST. Co-ordinator
 Planning and Environment Committee

FROM/EXP. Planning and Development Approvals Commissioner

SUBJECT/OBJET **NAMING REGIONAL ROAD 31, TOWNSHIP OF OSGOODE**

DEPARTMENTAL RECOMMENDATION

That the Planning and Environment Committee (acting as the Regional Street Name Committee) approve the following proposed street name.

That former provincial Highway 31 (now Regional Road 31) from approximately 200 metres south of Mitch Owens Road to the Osgoode/Stormont Dundas & Glengary boundary, be named "BANK STREET" (see Annex 1).

BACKGROUND

The above-noted Provincial Highway was transferred to the Region on 1 January, 1998. As a result, this new Regional Road 31 (formerly Regional Road 85) will have to be named. It should be noted that the section of former Highway 31 through the City of Gloucester was transferred to the Region on 1 April 1997 and was subsequently named "BANK STREET" on 22 October, 1997. It would seem appropriate therefore that former Highway 31 through the Township of Osgoode also be named Bank Street as it is a continuous Regional Road.

REGIONAL COMMENTS

The name "Bank Street" for this section of Former Highway 31 is the most appropriate because it is a continuation of this existing road from the Cities of Ottawa and Gloucester. In addition, having one continuous name for this road would be of great assistance to the 9-1-1 emergency services.

EXTERNAL AGENCIES

The Township of Osgoode supports the name “Bank Street” for former Highway 31, provided that the Region pay the costs of re-numbering all the properties along this road.

Since civic addressing is clearly a local municipal responsibility the Region will not absorb the costs associated with any re-numbering that will result from the naming of Regional Road 31 to Bank Street.

A letter (copy attached) from the Greely Business Association (GBA) supports the name “Bank Street” for this new section of Regional Road 31. The GBA states that since most local businesses depend on the support from City residents the proposed name Bank Street for this section would reinforce the view that Osgoode Township is closer to the City than they might think.

PUBLIC NOTIFICATION

The Legal Department has advised that the subject road can be named pursuant to the provisions of the Municipal Act, Section 21, paragraph 111. However, it is only in the instance of changing the name of a highway that publication is required. In this instance, the situation is one of giving a name to a highway and a publication is not required.

It should be noted that there were no public notifications for the section of Regional Road 31 through the City of Gloucester when it was named Bank Street in October 1997.

FINANCIAL IMPLICATION

No financial implications to the RMOC.

*Approved by
N. Tunnacliffe, MCIP, RPP*

Attach. (2)

LA/kc

ANNEX 1

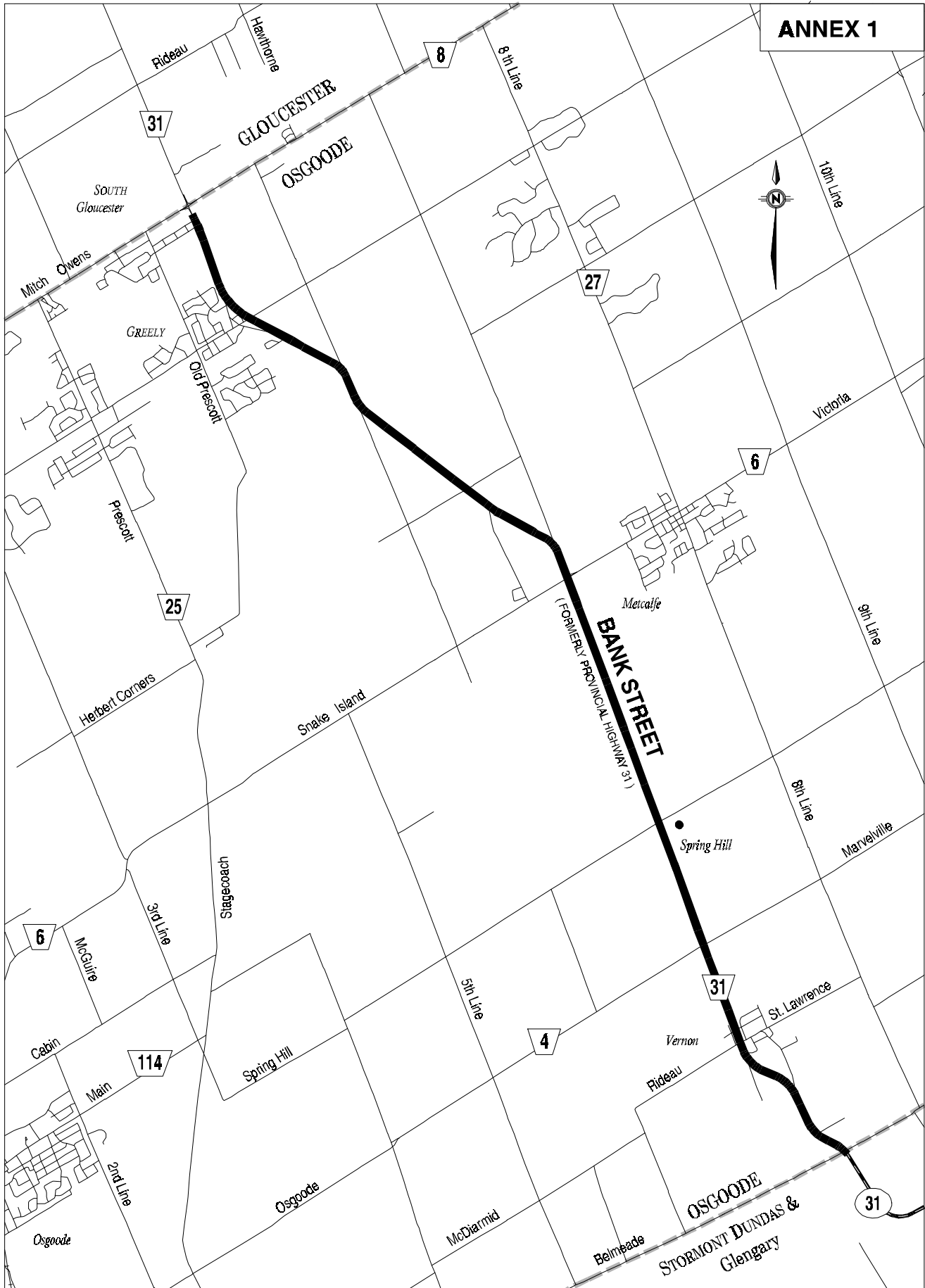



P.O. Box 111 Greely, Ontario K4P 1N6

Township of Osgoode
Economic Development Committee

February 25, 1998

Re: Naming of Regional Road 85

The RMOC has recently requested that the Township of Osgoode consider naming RR 85 as "Bank Street" for the section which run through its boundaries. The City of Gloucester has recently adopted this name for the section ending at Mitch Owens Rd.

In the opinion of The Greely Business Association, adopting the name would be beneficial to the business owners of Greely and Metcalfe as well as all business owners along RR 85.

As most local businesses require support from city residents and businesses it would be much easier for these potential customers to relate to the location of say Greely, Metcalfe and Vernon in relation to their location. A simple drive straight out Bank Street is all it would take.

In addition, the name would reinforce the view that Osgoode Township is closer to the city than they might think. A 10 to 20 minute drive along Bank Street to Parkway Rd or Victoria St.

One of the draw-backs of course is the cost of re-numbering addresses along the road. However this cost might be outweighed by the benefit of added income our business community would inevitably achieve as a result.

This association would like to obtain estimated figures on the cost of such re-numbering in order to give this matter further consideration while the opportunity is here to make this kind of change.

Please forward this information as soon as possible to the above address .

Thank You

Mike Vezina
The Greely Business Association

7